

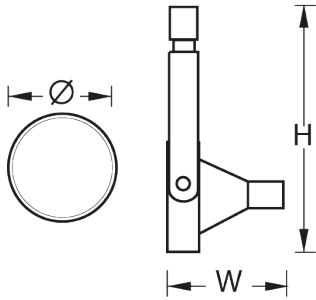

AU-DR007-007/1

SPECIFICATION

HOUSING	:HIGH COLD-ROLLED STEEL SHEET FORMED BY HIGH QUALITY MACHINE	COLOR	:WHITE, BLACK
SURFACE TREATMENT	:ION-PHOSPHATE AND ANTI-RUST FINISHED WITH UV RESISTANT POLYESTER POWDER COAT	PROTECTION CLASS	:PROTECTION CLASS EQUIVALENT TO IP 20
FRAME	:DIE-FORMED ALUMINIUM	INSTALLATION	:TRACK LIGHT
		APPLICATION	:CEILING MOUNT :DEPARTMENT STORE, SHOWROOM, SHOP, MUSEUMS, ETC.



MODEL	DIMENSION(mm.)			LAMP	LUMED	LAMP TYPE
	Ø	W	H	HOLDER	(MAX)	
AU-DR007	105	160	250	E 27	6900 cd.	PAR30 75W.
AU-DR007/1	105	160	300	E 27	9300 cd.	PAR38 120W.